

## Soils Map

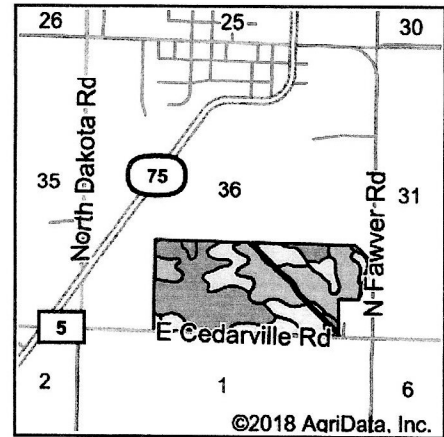

State: **Illinois**  
 County: **Stephenson**  
 Location: **36-28N-8E**  
 Township: **Dakota**  
 Acres: **133.98**  
 Date: **8/16/2018**

Maps Provided By:

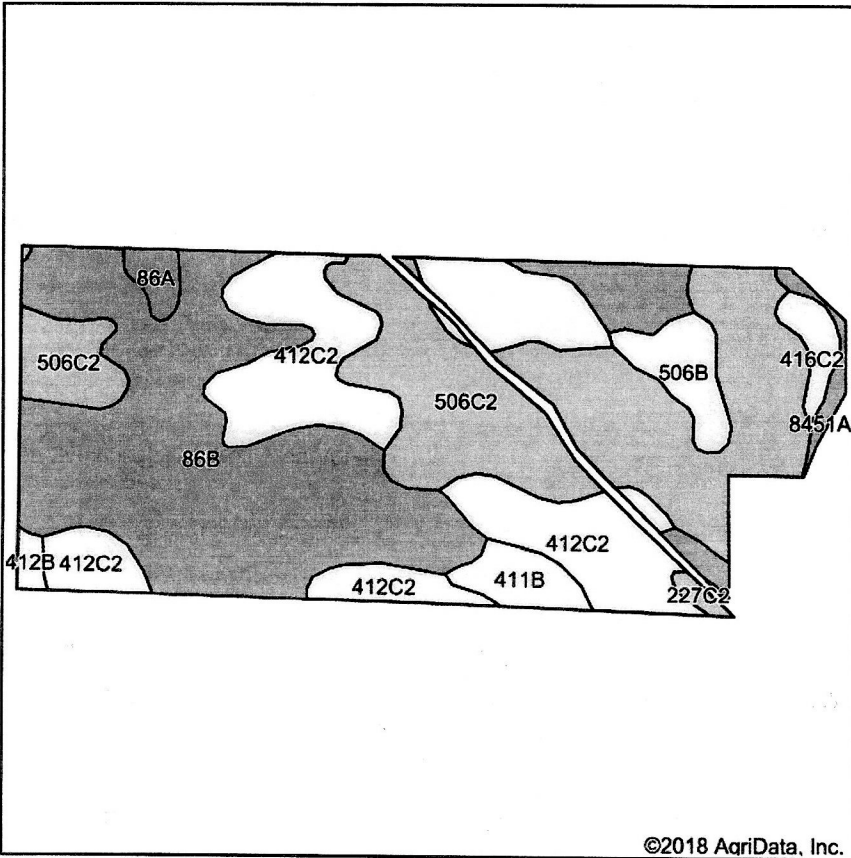

Soils data provided by USDA and NRCS.

Area Symbol: IL177, Soil Area Version: 11

Code	Soil Description	Acres	Percent of field	Il. State Productivity Index Legend	Corn Bu/A	Soybeans Bu/A	Crop productivity index for optimum management
**86B	Osco silt loam, 2 to 5 percent slopes	47.49	35.4%		**189	**59	**140
**506C2	Hitt silt loam, 5 to 10 percent slopes, eroded	39.67	29.6%		**147	**49	**110
**412C2	Ogle silt loam, 5 to 10 percent slopes, eroded	32.53	24.3%		**165	**53	**122
**506B	Hitt silt loam, 2 to 5 percent slopes	4.13	3.1%		**156	**52	**117
**411B	Ashdale silt loam, 2 to 5 percent slopes	3.14	2.3%		**168	**53	**124
8451A	Lawson silt loam, cool mesic, 0 to 2 percent slopes, occasionally flooded	2.16	1.6%		190	61	140
**416C2	Durand silt loam, 5 to 10 percent slopes, eroded	2.02	1.5%		**157	**52	**118
86A	Osco silt loam, 0 to 2 percent slopes	1.46	1.1%		191	60	141
**412B	Ogle silt loam, 2 to 5 percent slopes	0.77	0.6%		**175	**56	**130
**227C2	Argyle silt loam, 5 to 10 percent slopes, eroded	0.61	0.5%		**153	**50	**113
<b>Weighted Average</b>					<b>168.5</b>	<b>54.1</b>	<b>125.2</b>

**Table: Optimum Crop Productivity Ratings for Illinois Soil by K.R. Olson and J.M. Lang, Office of Research, ACES, University of Illinois at Champaign-Urbana. Version: 1/2/2012 Amended Table S2 B811**

Crop yields and productivity indices for optimum management (B811) are maintained at the following NRES web site: <http://soilproductivity.nres.illinois.edu/>

\*\* Indexes adjusted for slope and erosion according to Bulletin 811 Table S3

\*c: Using Capabilities Class Dominant Condition Aggregation Method

Soils data provided by USDA and NRCS. Soils data provided by University of Illinois at Champaign-Urbana.